

Y-Splitters

BCC M415-M415-M415-U2100-007

Order Code: BCC0KNJ

BALLUFF

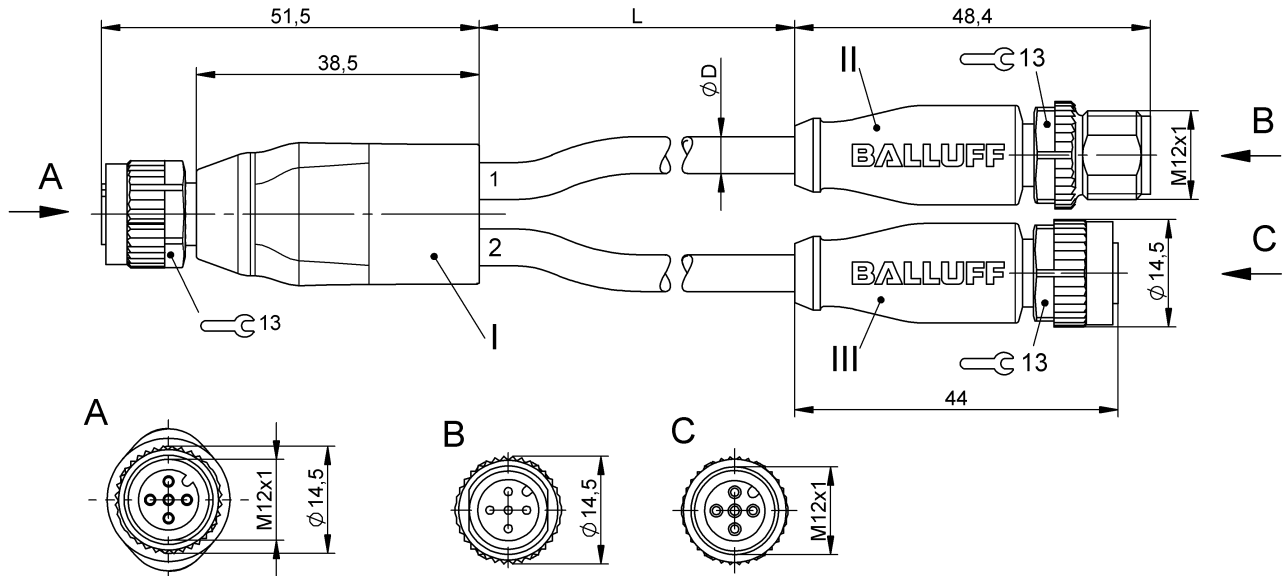

Basic features

Application	DeviceNet Thin
Approval/Conformity	CE WEEE

Electrical connection

Bending radius min., fixed cable	5 x D
Bending radius min., flexible cable	10 x D
Cable diameter D	7.20 mm ±0.30 mm
Cable, bending cycles min.	1 mil.
Conductor cross-section	22 AWG/24 AWG
Connection 1	M12x1-Female, straight, 5-pin, A-coded
Connection 2	M12x1-Male, straight, 5-pin, A-coded
Connection 3	M12x1-Female, straight, 5-pin, A-coded
Connector 01, version	straight
Connector 02, version	straight
Connector 03, version	straight
Number of conductors	4/4
Number of pins	5/5/5
System	Molded/Molded/Molded

Electrical data

Conductor construction	2x2 twisted-pair
Operating voltage Ub	60 VDC / 60 VAC
Rated current (40 °C)	4.0 A
Surge impedance	120 Ohm ±12 Ohm

Environmental conditions

Cable temperature, fixed routing	-40...80 °C
Cable temperature, flexible routing	-20...80 °C
IP rating	IP67, IP68, IP69K/IP67, IP68, IP69K

Material

Cable jacket material, note	Shielded
Cable jacket, material	PUR
Cable shield	Aluminum foil and copper braid
Material contact carrier	PUR/PUR/PUR
Material contacts	Bronze/Brass/Bronze
Material cover nut	Die-cast zinc/Die-cast zinc/Die-cast zinc
Material grip	PUR/PUR/PUR

Mechanical data

Acceleration max., drag chain	5 m/s ²
Cable jacket, color	violet
Cable length L	0.70 m
Cable properties	drag chain compatible
Tightening torque pigtail	0.6 Nm/0.6 Nm/0.6 Nm
Traverse speed max., drag chain	200 m/min

Remarks

Cable construction acc. to UL-AWM Style 20236
 Flame resistance acc. to IEC 60332-1 and VW1 UL1581
 Enclosure rating per IEC 60529 or 20653, only in screwed state with the associated mating piece.

Connector Drawings

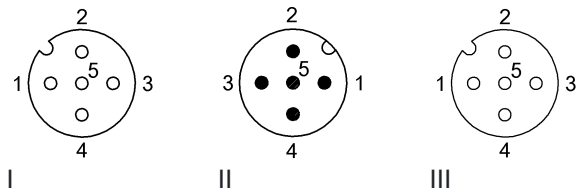

Wiring Diagrams

